



ELECTRONICS

PRESENTING OUR NEW RANGE
FROM PLATINUM TOOLS



PLATINUM[®]
TOOLS

Prep and Crimping ezEX-RJ45™ Connectors

1. Remove cable jacket leaving 1" to 1 1/2" of conductors. If there is a pair separator, remove it by cutting flush at the end of the cable.
2. Untwist all 4 pairs and comb out all twists so conductors can lay side by side with no gaps. Configure your pairing to the T568 A or B. See chart below.
3. Cut all 8 ends even, insert into rear of connector, and push through and out the front end.

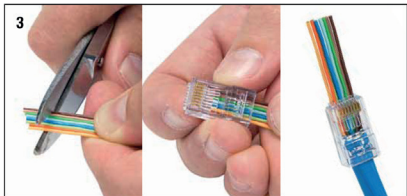
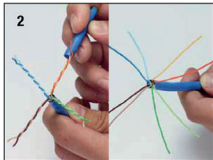
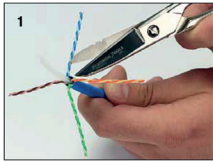

4. Insert prepped connector into the EXO Die™ and listen for the 'click'. It is now 'locked' in and ready to be crimped. Squeeze handles together slowly until they come to a stop. Release, unlock the connector and remove from the EXO Die.



Ready to use

T568A/T568B Wiring Chart

Wire	1	2	3	4	5	6	7	8
T568A	W/G	G	W/O	BL	W/BL	O	W/BR	BR
T568B	W/O	O	W/G	BL	W/BL	G	W/BR	BR

Using the EXO Crimp Frame™

5. To Unlock squeeze handles together and hold, pushing the lock button on the back side all the way through to the front side and release the handles. The tool will now open.
6. To Lock squeeze handles together and hold, pushing the lock button on the front side all the way through to the back side and release handles. The tool is now in closed/locked position.
7. Removing EXO Die™ Using both thumbs (see 7.1), simultaneously push in the locking tabs (see 7.2), and while holding in place, push the EXO Die toward and out the backside of the EXO Crimp Frame. Keep die set parallel to the frame to prevent jamming (see 9).
8. Replacing EXO Die™ Same as removing the die set BUT in reverse.
9. Keep die set parallel to frame to prevent jamming for both removing or replacing.

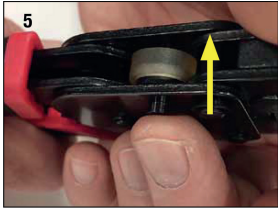

EXO Crimp Frame™ with Black Die

P/N 100061C

EZEXOCRIMPBLK

Black



The new ezEX-RJ45™ Termination System provides a solution for terminating larger diameter twisted-pair cables, with conductor sizes up to .048". The ezEX-RJ45™ connector has a hi-lo stagger design to increase performance and accommodate larger conductors found in Cat5e, Cat6, and Cat6A cables while maintaining the EZ® pass through design. This allows you to verify the wiring sequence before terminating. The new EXO™ professional crimp tool and EXO-EX die set pair with the ezEX-RJ45™; connectors to ensure a flush cut and reliable termination every time. Saving time and money without sacrificing performance on high end jobs.

ezEX-RJ45™ Connectors:

- 2 connectors for conductors ranging .039" – .048"
- Pass through design allows for easy verification of wiring sequence
- One-piece design — bars or liners are not required
- Rated up to 10 Gigabit for superior performance
- Works with solid or stranded conductors
- FCC, RoHS 2 & UL compliant
- Made in USA

EXO-EX Crimp Tool Frame and Dies:

- One-step to crimp and flush cut/trim ezEX-RJ45™ conductors
- Die sets are easily interchangeable
- Reversible die sets for ambidextrous operation
- Connectors lock into die set port for easier crimping
- Push button lock for easy storage
- Ergonomic Comfort Grip TPR Handles

EZEX44 and EZEX48 plugs for use with EZEXO Tool with Black insert

EZEX44

Plug

EZEX48

Plug



EXO Crimp Frame™ with Blue Die

P/N 100062C

EZEXOCRIMPBLUE	Blue
-----------------------	------



The patented EXO Crimp Frame + EZ-RJ45® Die was designed for termination of EZ-RJ45® connectors. The included EZ-RJ45® Die is interchangeable and reversible when used with EXO Crimp Frame. Designed for the original pass through EZ-RJ45® connectors which are a standard in the industry. The EXO Crimp Frame highlights a push button lock, ergonomic TPR handles, and works with the EXO-EX Die™ (P/N 100071C) for terminating ezEX-RJ45™ connectors.

Technical / Features:

- Single cycle crimp and flush trim
- EZ-RJ45® Die is easily interchangeable
- Reversible EZ-RJ45 Die for ambidextrous operation
- Connectors lock into tool for correct positioning during crimp
- Push button lock for easy storage
- Ergonomic comfort grip TPR handles
- Includes the EZ-RJ45® Die for crimping EZ-RJ45® Connectors
- Compatible with EZ-RJ45 connectors: EZ-RJ45 Cat5e and Cat6, Shielded Cat5e and Cat6 connectors (internal and external ground)

EZCAT5/EZCAT6 plugs for use with EZ Tool and EZEXO Tool with Blue insert die

EZCAT5	for CAT5
---------------	----------

EZCAT6	for CAT6
---------------	----------



Black EXO-EX Die For Crimp Frame**P/N 100071C****EZRJ45DIE**

Black



The patented EXO-EX Die™ is used with the EXO Crimp Frame™ to terminate ezEX RJ45™ connectors (typically used in Cat6 and Cat6A). The EXO-EX Die is interchangeable and reversible when used with EXO Crimp Frame. Designed for the new ezEX-RJ45™ connectors (ezEX™44 and ezEX™48). The ezEX-RJ45™ connectors are an RJ45 pass through connector, developed for larger cables and conductors. Integrated Hi-Lo stagger for improved performance and one piece design pass through system.

Technical / Features:

- Single cycle crimp and flush trim
- Easily interchangeable
- Reversible for ambidextrous operation
- Connectors lock into tool for correct positioning during crimp
- Compatible with ezEX™44 and ezEX™48 connectors
- Terminates larger cables and conductors Cat6 and Cat6A

Blue EXO-EX Die For Crimp Frame**P/N 100072C****EZRJ45DIE**

Blue



The patented EZ-RJ45® Die is used with the EXO Crimp Frame™ to terminate EZ-RJ45® connectors. The EZ-RJ45® Die is interchangeable and reversible when used with EXO Crimp Frame™. Designed for the original pass through EZ-RJ45® connectors which have been a standard in this industry for many years.

Technical / Features:

- Single cycle crimp and flush trim
- EZ-RJ45® Die is easily interchangeable
- Reversible EZ-RJ45® Die for ambidextrous operation
- Connectors lock into tool for correct positioning during crimp
- Compatible with EZ-RJ45 connectors: EZ-RJ45 Cat5e and Cat6, Shielded Cat5e and Cat6 connectors (internal and external ground)

CAT 6A 10GIG Crimp Tool

P/N 12516C

CAT6ACRIMP**CAT 6A 10GIG Connector**

P/N 106190

CAT6ASHIELD**Technical / Features:**

- Exceeds 10-Gig performance standard
- UL and RoHS compliant
- Max cable OD: 0.335"/8.5mm
- Max conductor OD: 0.053"/1.35mm

The next generation in our 10Gig Termination System combines two crimpers into a single tool, making 2-step crimping simple. First, insert the 10Gig connector into the front end to terminate the contacts and switch to the back end to crimp the external ground. Like the original, the new Tele-TitanXg 2.0, along with our 10Gig shielded connectors, are engineered specifically for CAT6A cables to provide true 10Gig performance each and every time.

Technical / Features:

- One tool does the job of two tools
- Improve efficiencies by not having to change out tools in the middle of your termination
- Straight action crimp achieved with minimal hand force
- Compact and rugged design
- Terminates to industry specified crimp heights
- Gun-style lock for secure closure
- Non-slip handle and finger grooves for comfortable grip and control
- Not to be used with EZ-RJ45 or standard RJ45 modular plugs

Application:

- RJ45 CAT6A/10Gig Shielded RJ45 connectors
- CAT6e, CAT6A, CAT7 & over-sized CAT5e/6 industrial Ethernet cables
- Standard RJ12/11 connectors



www.gjelectronics.co.uk

Units 10-12 Wembdon Business Centre, Bower Road, Smeeth, Ashford, KENT, TN25 6SZ
Email: sales@gjelectronics.co.uk Tel: 01303 814 224 Fax: 01303814073